

Cofrasol 60

Cofrasol 60 is the most popular lost formwork profile. Depending on the targeted slab thickness, it permits to create formwork with spans of up to 3,0m without any temporary propping. After pouring of the concrete and its full hardening, the metal shuttering remains in place or could be cut off. It has no further function for the mechanical stability of the additionally reinforced concrete slab.

- Cofrasol 60 floors consist of steel profiles suitable for formwork while pouring and hardening of the concrete
- Is self-bearing over spans up to 3,0m
- Does not contribute to the final structural resistance of the floor slab
- Permits to construction concrete slabs where the access of normal formwork is difficult
- No need to remove formwork after concreting resulting in time savings

[Contact us](#)

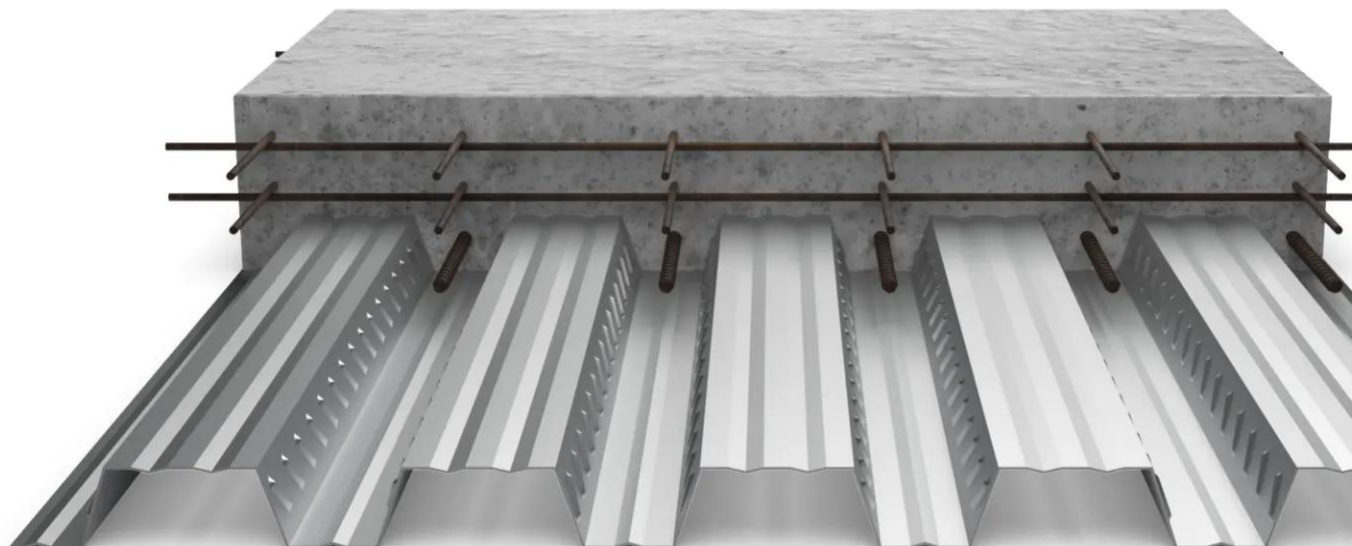

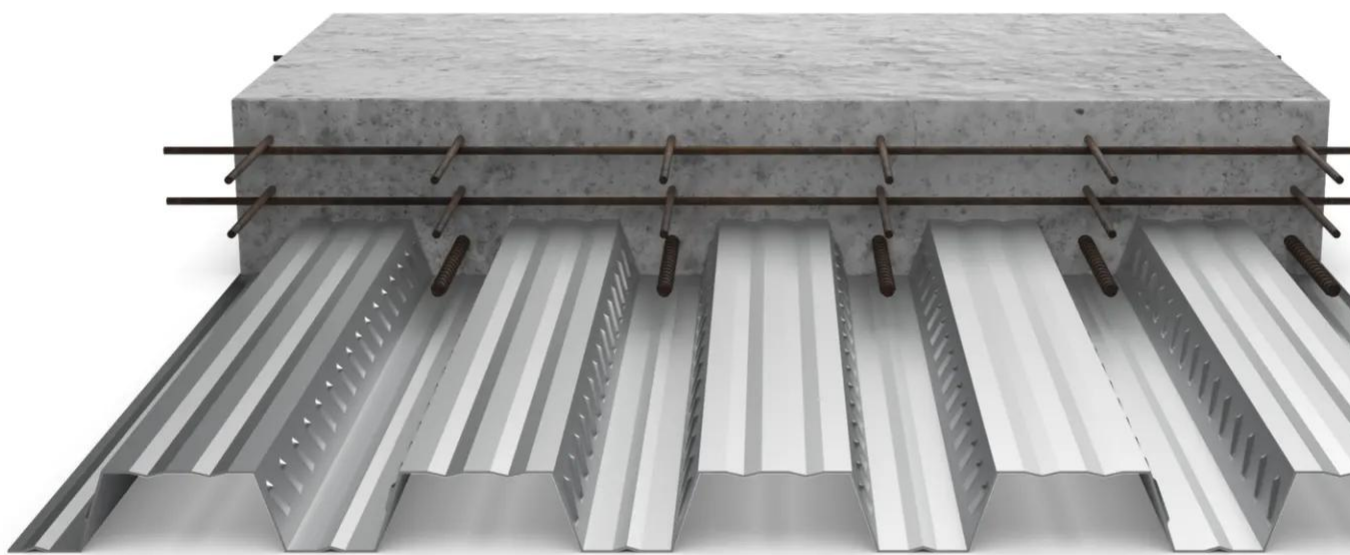
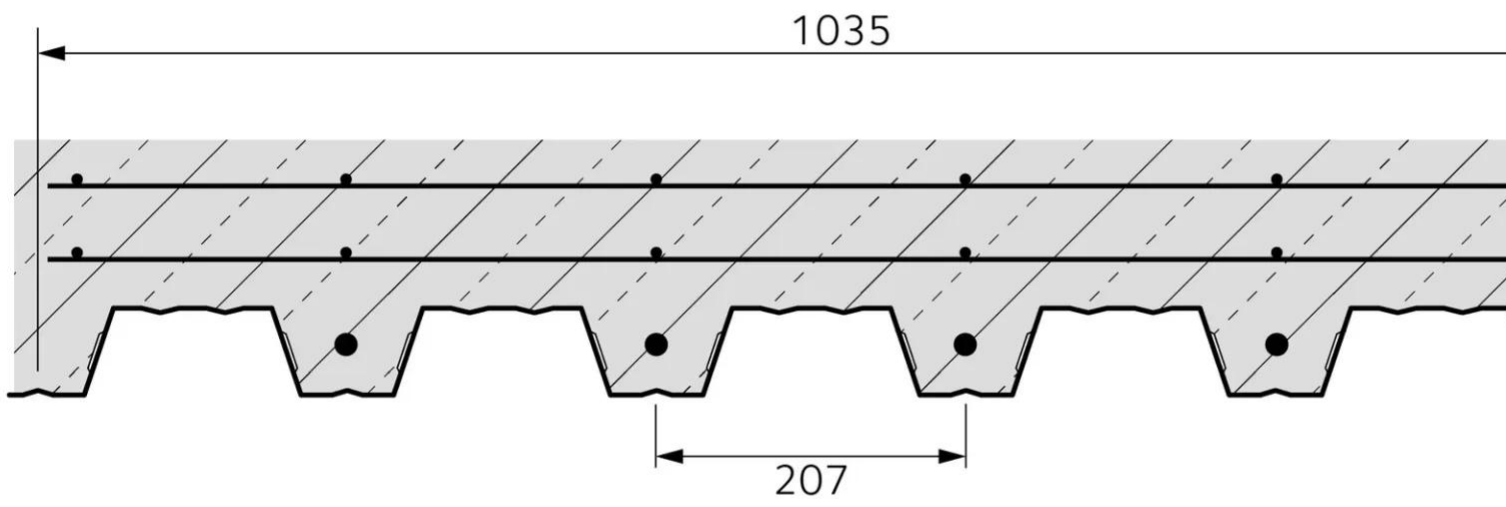

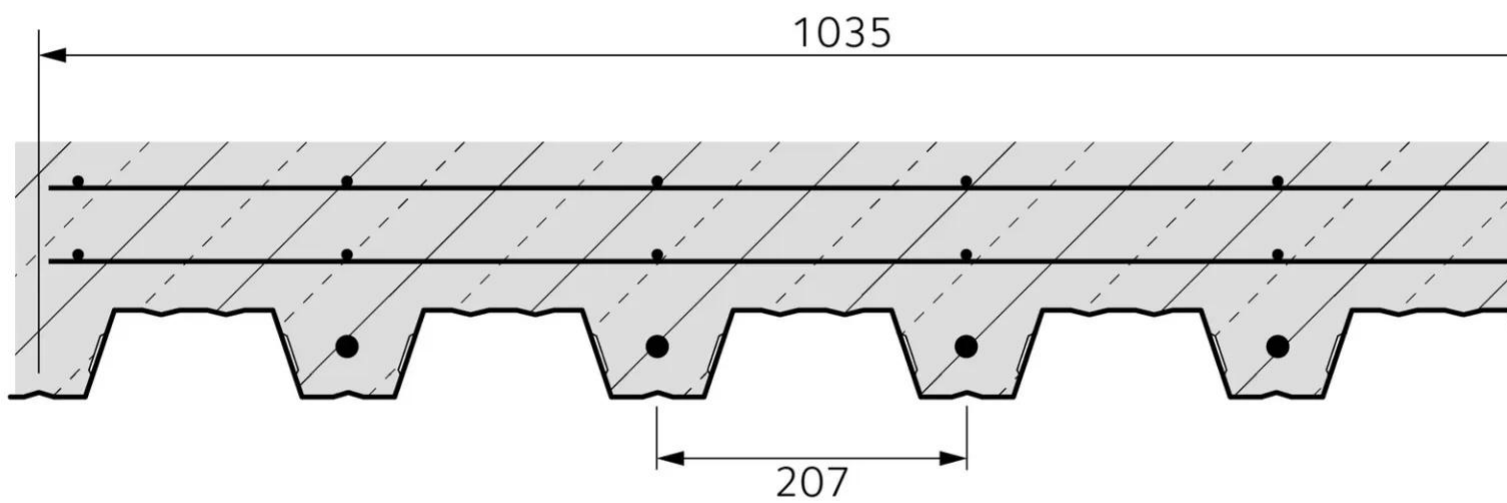

Properties

Accessories

[Request informations](#)

Related products

[Request informations](#)

Technical documents

[Request informations](#)

Technical & commercial documentation

[Request informations](#)