

Globalroof® CIN 339T2

CIN 339 T2 is a flat roof system made of roof steel deck and an inner face of structural perforated trays providing excellent acoustic and sound insulation and Up 0.15W/m².K. The system is installed in a parallel or perpendicular grid.

Composition

- Non bearing tray Hacierco C 500.90 perforated P in thickness 0.75mm
- Cleats or steel spacer
- Mineral wool Sorock in thickness 90mm (Rockwool) (black glass veil)
- Profile Trapéza 11.100.8 B in thickness 1.00mm
- Bituminous weight 5kg/m²
- Purlin Multibeam
- Mineral wool Torock 120mm thick (Rockwool)
- Roof deck Hacierco 40 SR in thickness 0.75mm (thickness subject to verification)
- Mineral wool Rockacier 120mm thick (Rockwool)
- Multi layer bituminous waterproof membrane

Performance and characteristics

- Sound reduction index $R_w(C;Ctr) = 57(-4;-12)$ dB
- Acoustic absorption $\alpha_w = 0.95$
- Thermal transmittance $Up = 0.15W/m^2.K$ estimated
- Weight: 69kg/m²
- Spacing: 43cm

[Contact us](#)



-

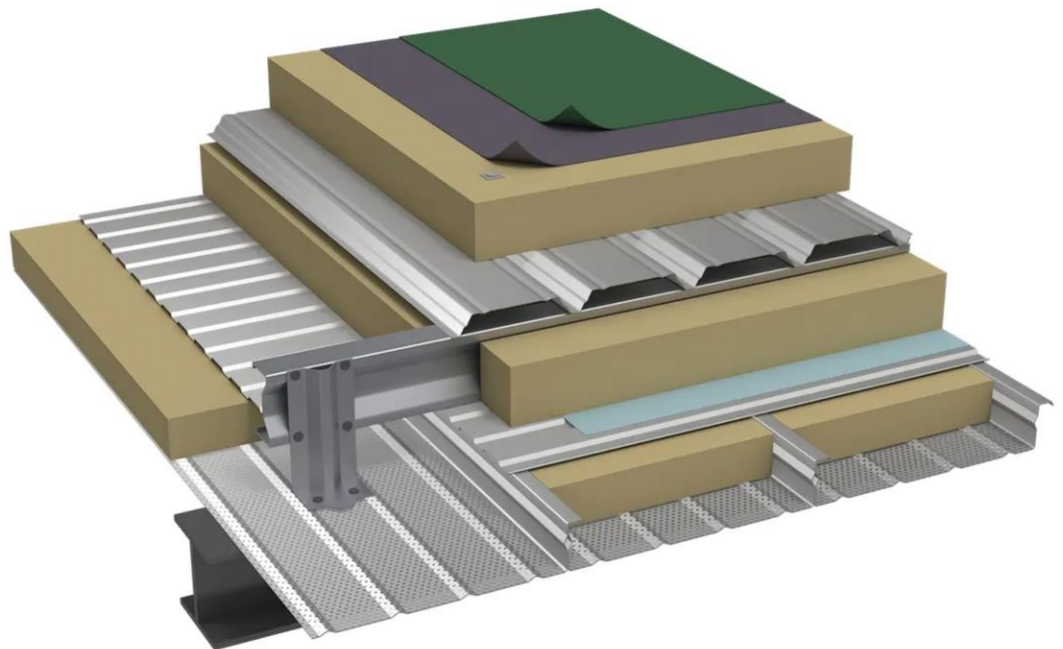

-

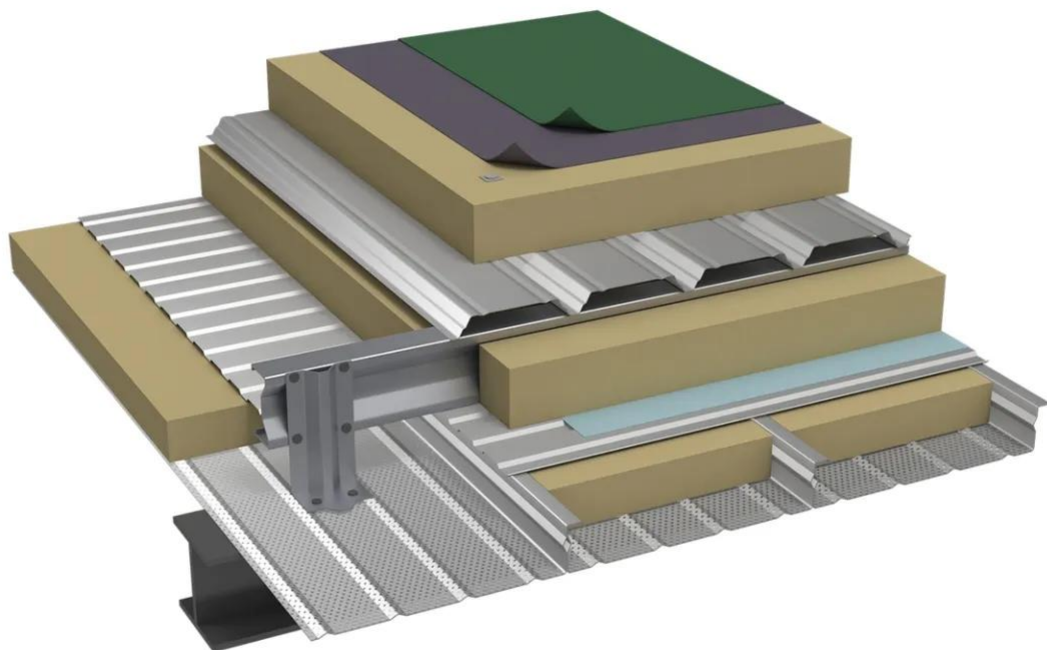

Properties

Accessories

[Request informations](#)

Related products

[Request informations](#)

Technical documents

[Request informations](#)

Technical & commercial documentation

[Request informations](#)