

## Globalroof® CIN 320TPR

CIN 320 TP R is a double skin system with an inner structural perforated tray and an external steel profile. The sytem offer a very high level of acoustic absorption and sound insulation and Up of 24W/m².K.

Composition :

- Non load-bearing tray Hacierco C 500.90 perforated P in thickness 0.75mm
- Cleats
- Mineral wool Sorock 70mm thick (Rockwool) (black glass veil)
- Vapor barrier
- Purlin Multibeam
- Mineral wool Torock 200mm thick
- Additionnal glass wool insulation nipped on purlin to fill the air gap
- Profile Trapeza. Frequence or Authentique in thickness 0.75mm

Performances and characteristics :

- Sound reduction index  $R_w(C;Ctr) = 47(-5;-13)$  dB
- Acoustic absorption  $\alpha_w = 0.95$
- Thermal transmittance  $U_p = 0.24W/m^2.K$  estimated
- Weight: 31kg/m²
- Spacing: 29cm .not including the height of the external weather profile

[Contact us](#)



•

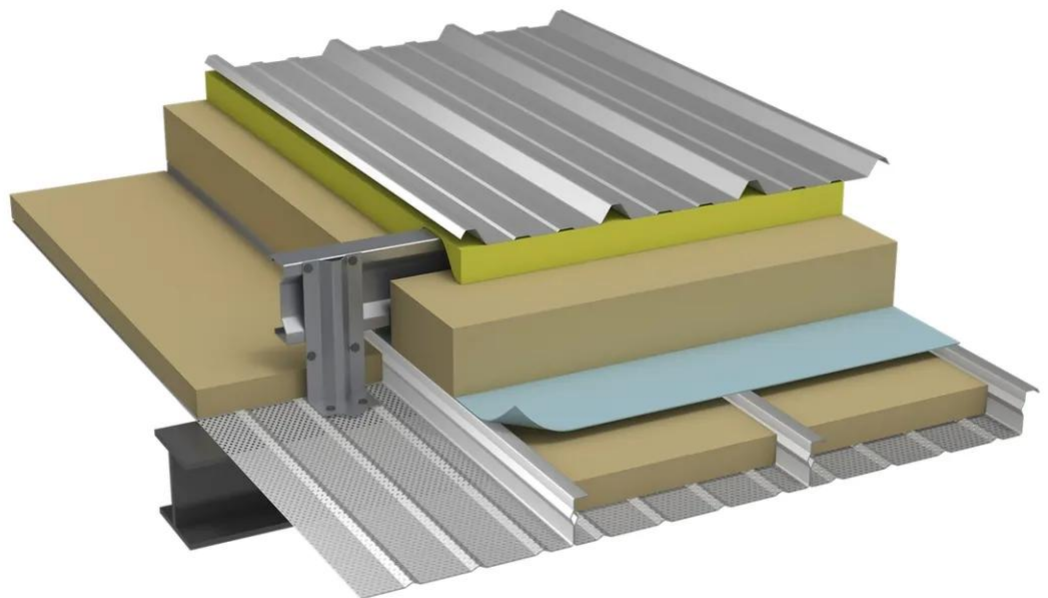

•

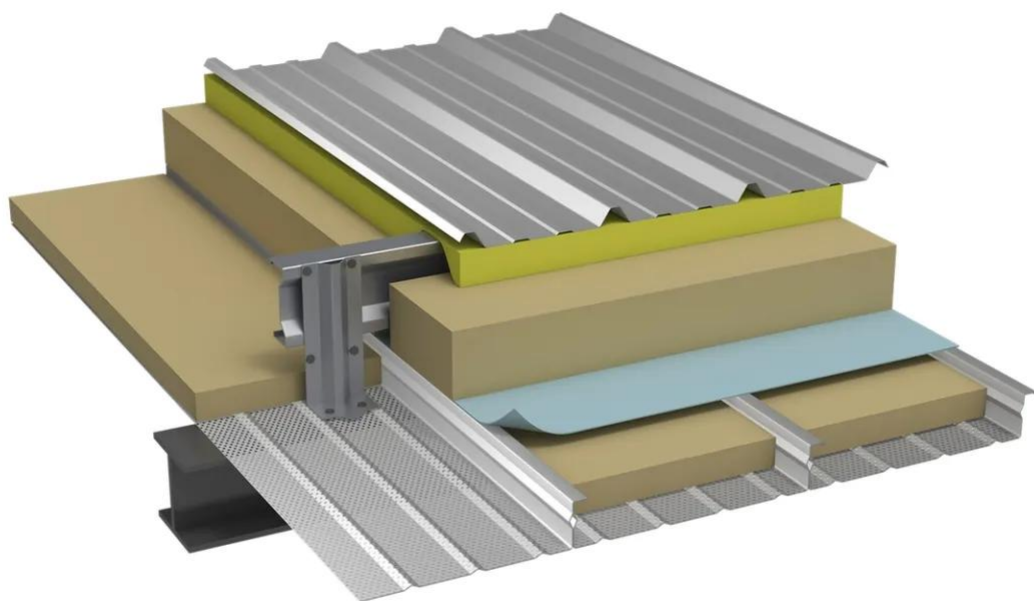

## Properties

## Accessories

[Request informations](#)

## Related products

[Request informations](#)

## Technical documents

[Request informations](#)

## Technical & commercial documentation

[Request informations](#)