

Globalroof® IN 224TR

Double skin system with an inner structural tray and an external profile with a minimum thickness of 0.75mm. It provides a very high level of sound insulation. The estimated Up is 24W/m².K.

Composition :

- Non load bearing tray Hacierco C 500.90 in thickness 0.75mm
- Cleats
- Mineral wool Sorock 70mm thick (in the bottom of the tray)
- Vapor barrier
- Purlin
- Mineral wool Torock 200mm thick
- Additionnal glass wool insulation clamped on purlin to fill the air gap
- Profile Trapeza. Frequence ou Authentique in thickness 0.75mm

Performances

- Sound reduction index $R_w(C;Ctr) = 53(-5;-13)$ dB
- Thermal transmittance $U_p = 0.24\text{W/m}^2\cdot\text{K}$ estimated
- Weight: 31kg/m²
- Spacing: 29cm .not including the height of the external weather profile

[Contact us](#)



•

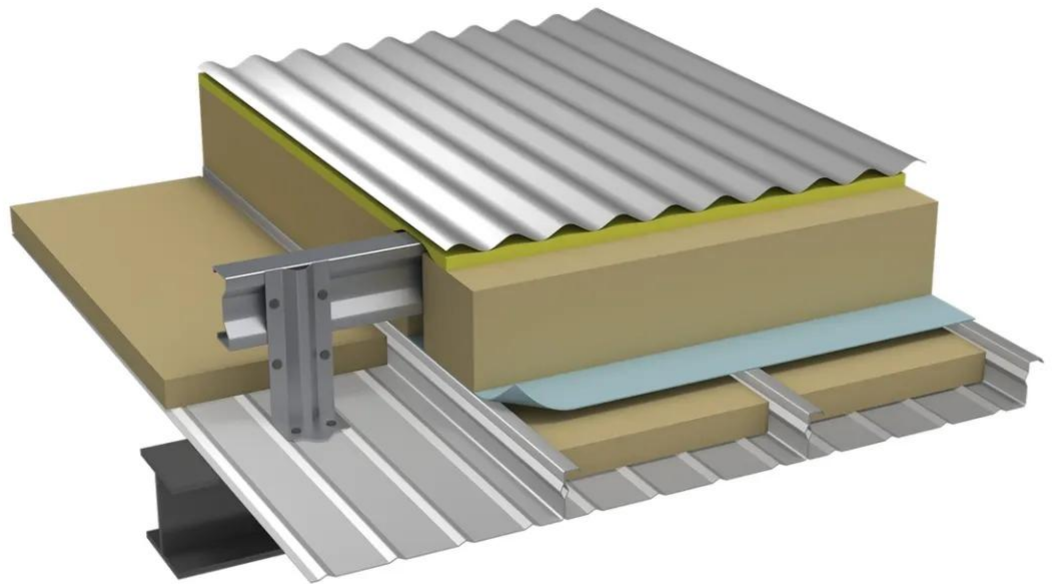

•

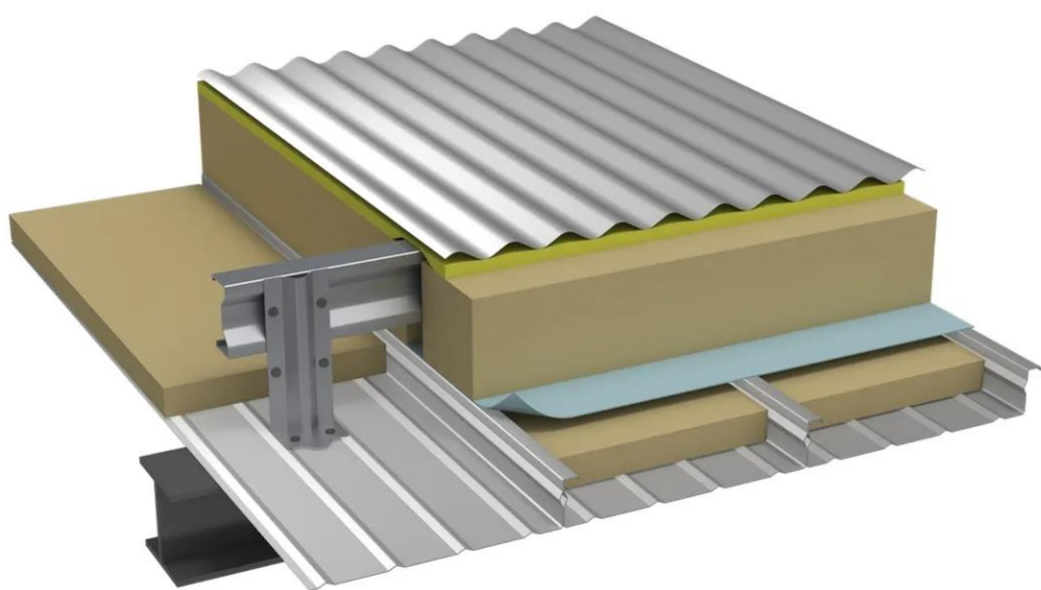

Properties

Accessories

[Request informations](#)

Related products

[Request informations](#)

Technical documents

[Request informations](#)

Technical & commercial documentation

[Request informations](#)