

## Globalroof® CIN 323TP

CIN 323 TP is a double skin system with an inner structural perforated tray and an external steel profile with a minimum thickness of 1.25mm. The system delivers a very high level of sound insulation and exceptional acoustic absorption. The system has an estimated thermal performance Up of 0.15W/m².K.

Composition :

- Non load-bearing tray Hacierco C 500.90 perforated P in thickness 0.75mm
- Cleats or steel spacer
- Mineral wool Sorock 70mm thick(Rockwool) (black glass veil)
- Vapor barrier
- Purlin Multibeam
- Mineral wool Torock in thickness 200mm (Rockwool)
- Additionnal glass wool insulation nipped on the purlin to fill the air gap
- Profile Trapeza in thickness 1.25mm

Performances and characteristics :

- Sound reduction index  $R_w(C;Ctr) = 50(-5;-13)$  dB
- Acoustic absorption  $\alpha_w = 0.95$
- Thermal transmittance  $U_p = 0.24\text{W/m}^2\cdot\text{K}$  estimated
- Weight: 35kg/m²
- Spacing: 29cm. not including the height of the external weather profile

[Contact us](#)

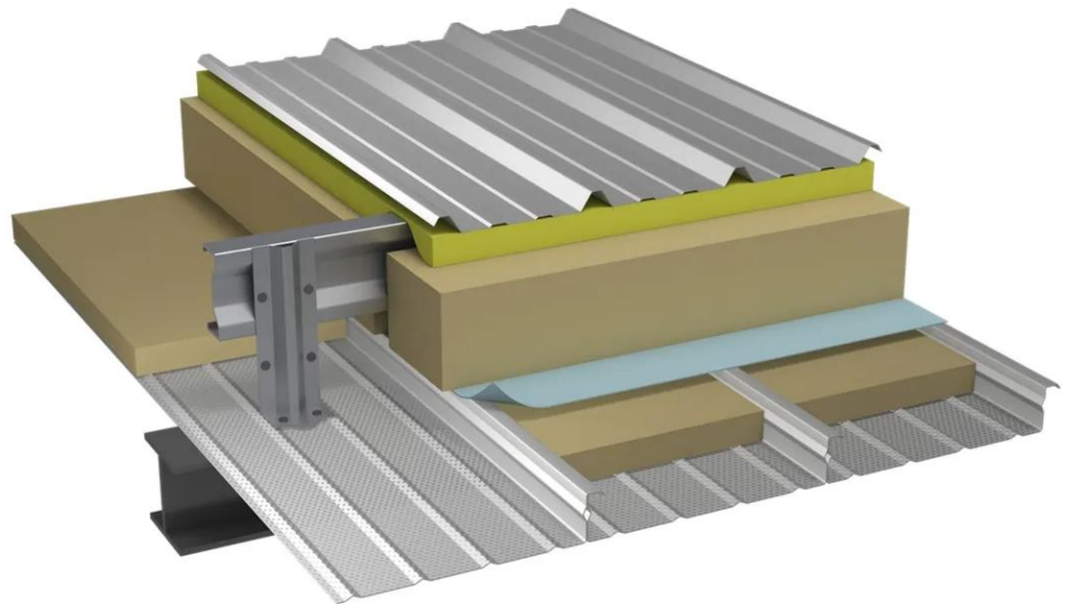

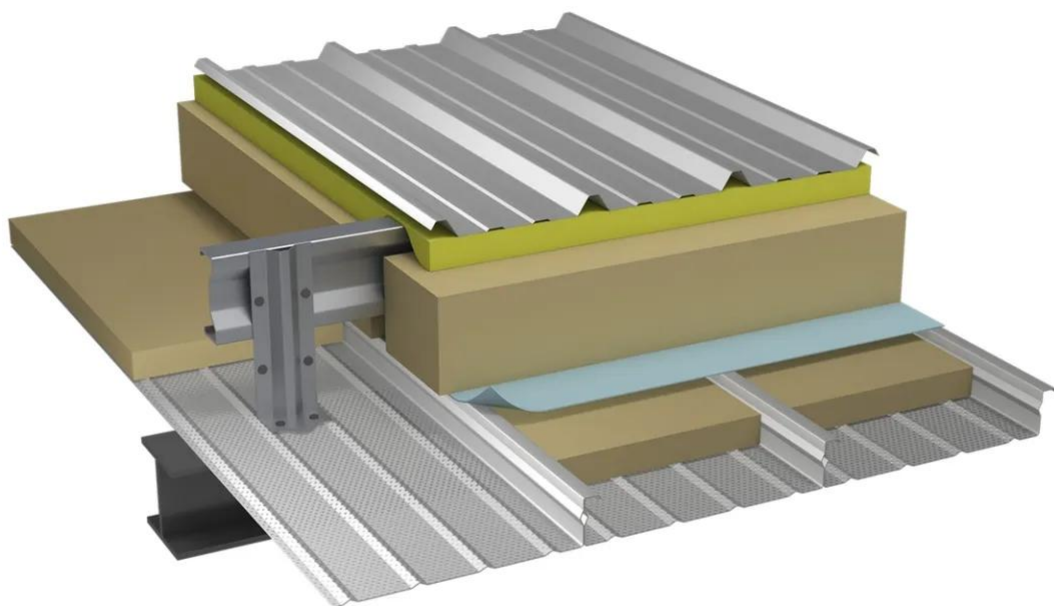

## Properties

## Accessories

[Request informations](#)

## Related products

[Request informations](#)

## Technical documents

[Request informations](#)

## Technical & commercial documentation

[Request informations](#)