

Ondatherm L

Ondatherm® L is an economical roof sandwich panel with a cover width of 1000mm made of two steel sheets and a polyisocyanurate foam.

- Lighter panels especially developed to meet the needs of agricultural market
- Thickness of facings: External side 0.40 mm/Internal side 0.40 mm
- 3 thicknesses of insulation core available: 40, 60, 80 mm
- Available in 4 colours of polyester 25µm: RAL 5008, 7016, 8012, 7022
- Visible fixings
- Outer facing is trapezoidal
- Compatible with our transluscents

[Contact us](#)

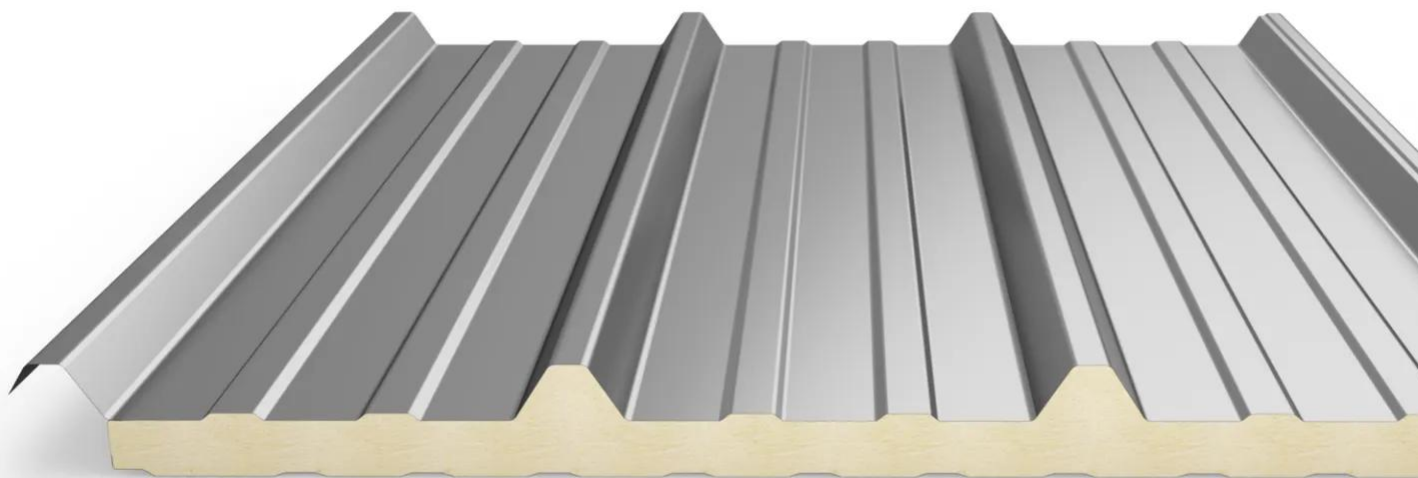

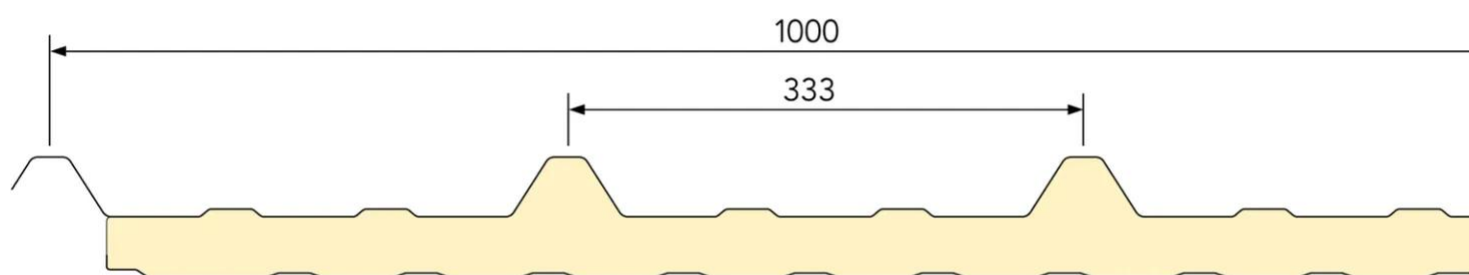
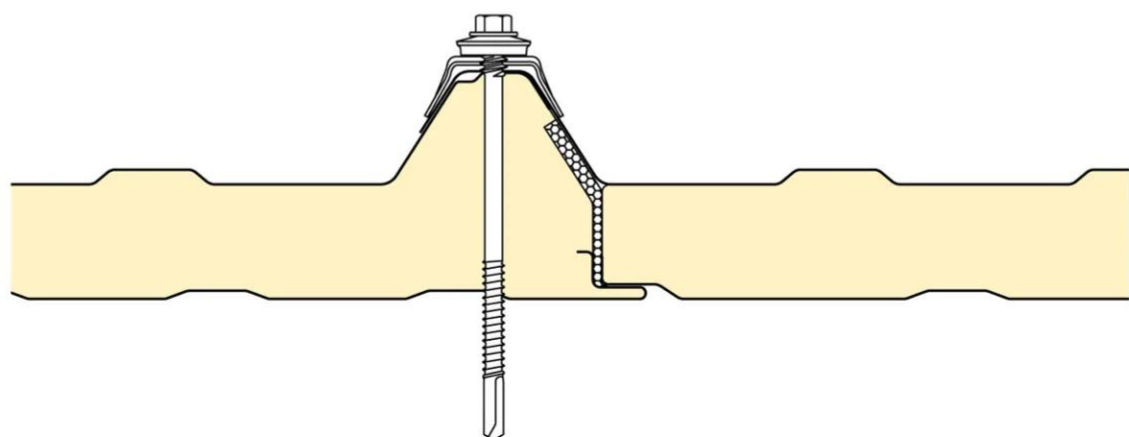
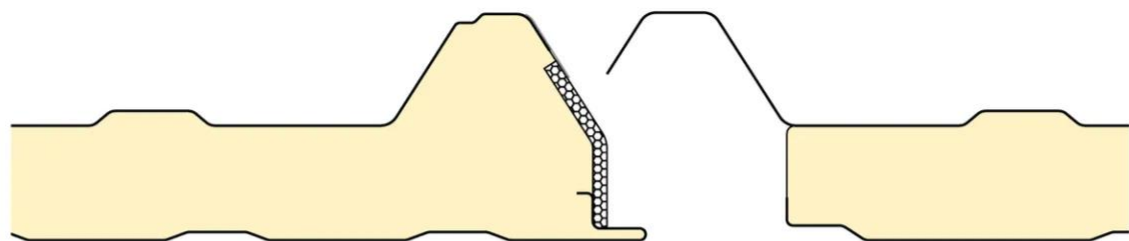

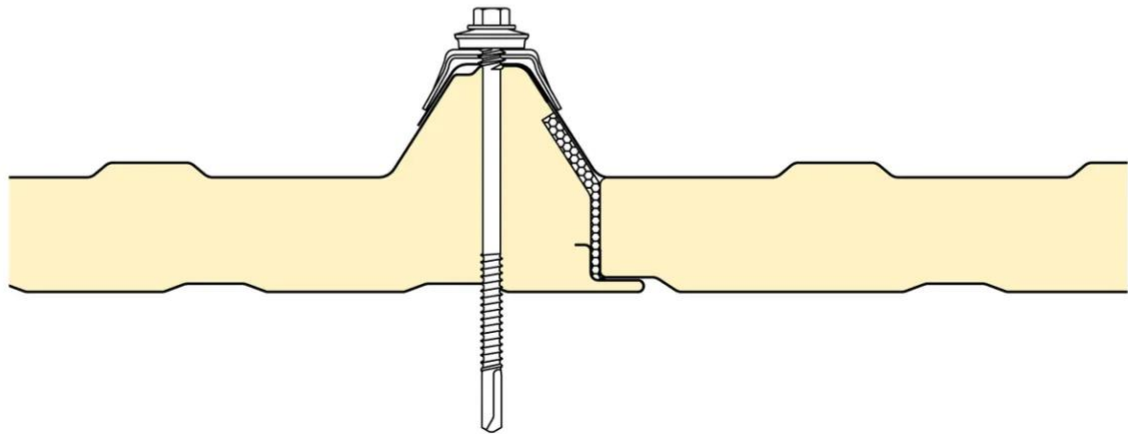
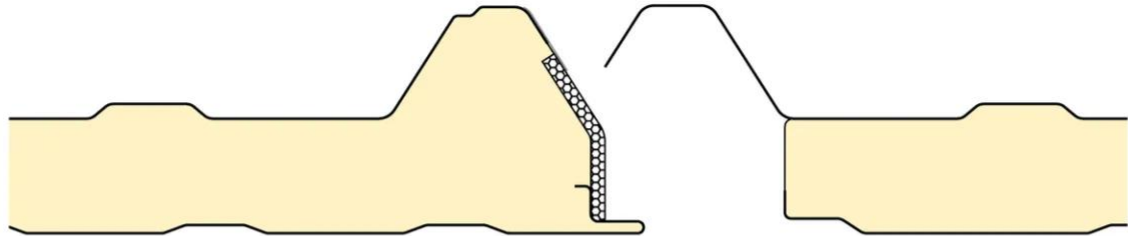
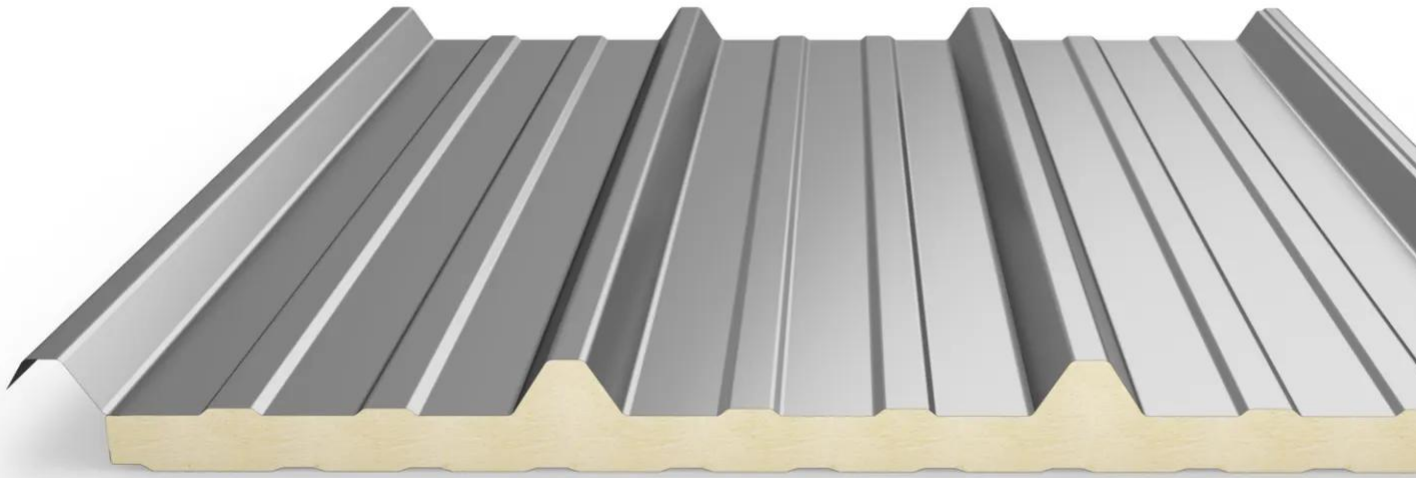

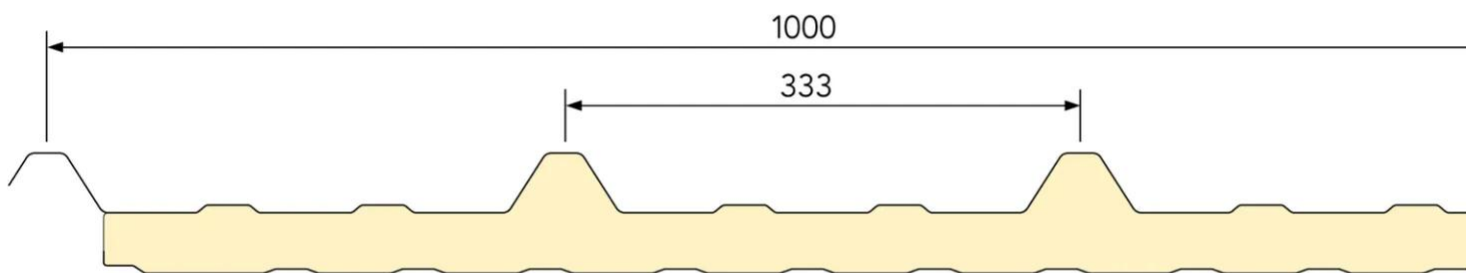

Properties

Accessories

[Request informations](#)

Related products

[Request informations](#)

Technical documents

[Request informations](#)

Technical & commercial documentation

[Request informations](#)