

## Ondatherm® TH

This roof insulated sandwich panel is specially designed for high hygrometry buildings. Made of a polyisocyanurate (PIR) and two prepainted steel facings, its outer facing is trapezoidal.

- Cover width: 1 000 mm
- For high to very high hygrometry buildings
- PIR Foam PRT Hexacore®
- ACERMI certification
- Excellent airtightness thanks to the nesting and joints system minimizing thermal bridges
- Validated for use in 10 types of Public Access Buildings (ERP) - [Contact us](#)
- Standard thickness of facings: External side 0.60 mm/Internal side 0.40 mm
- 8 thicknesses of insulation core available, from 30 to 140 mm
- Visible fixings

[Contact us](#)

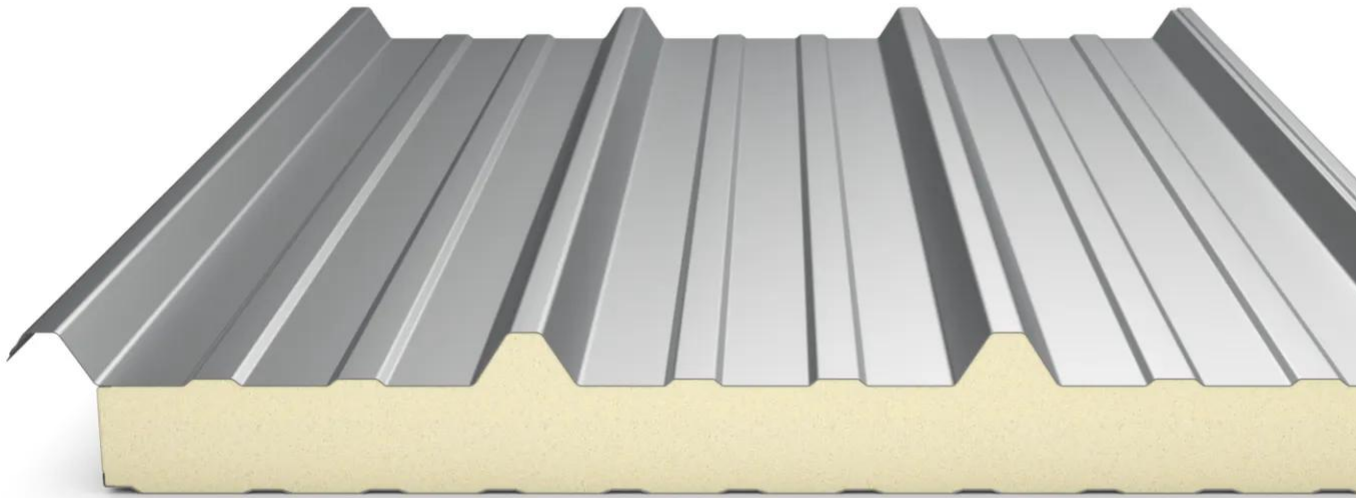

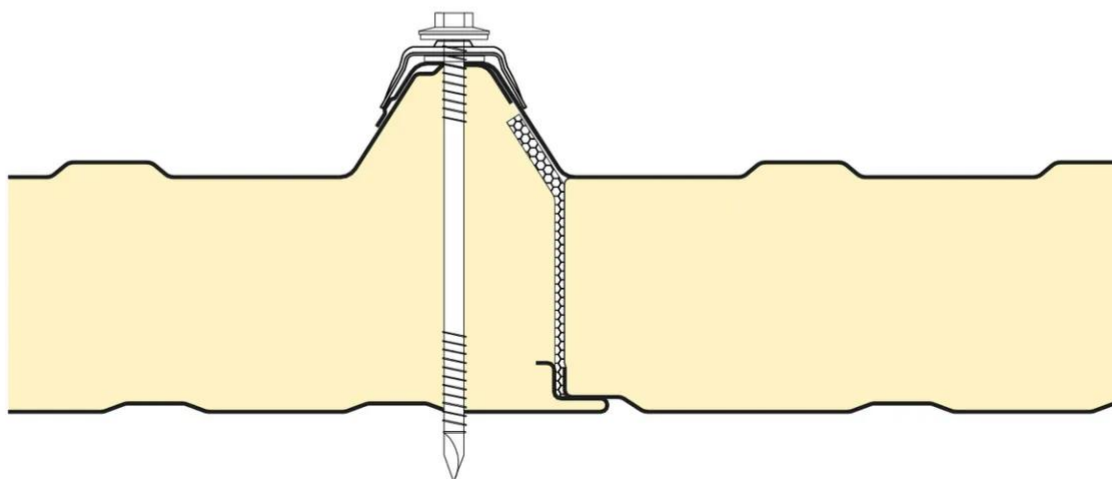
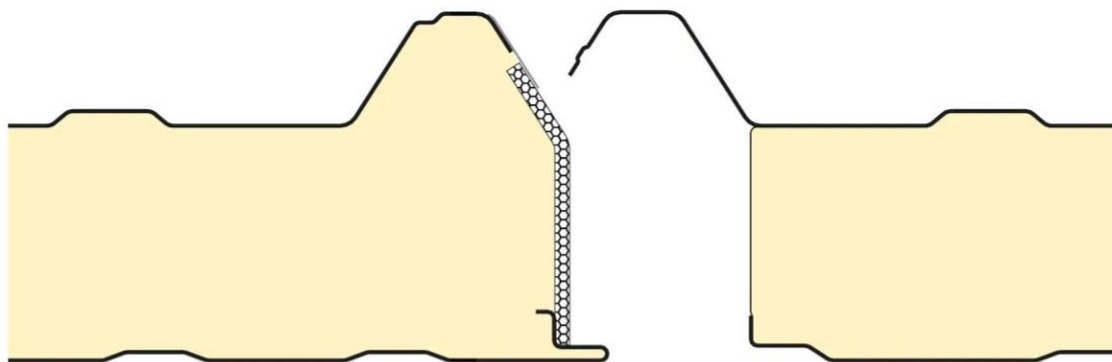
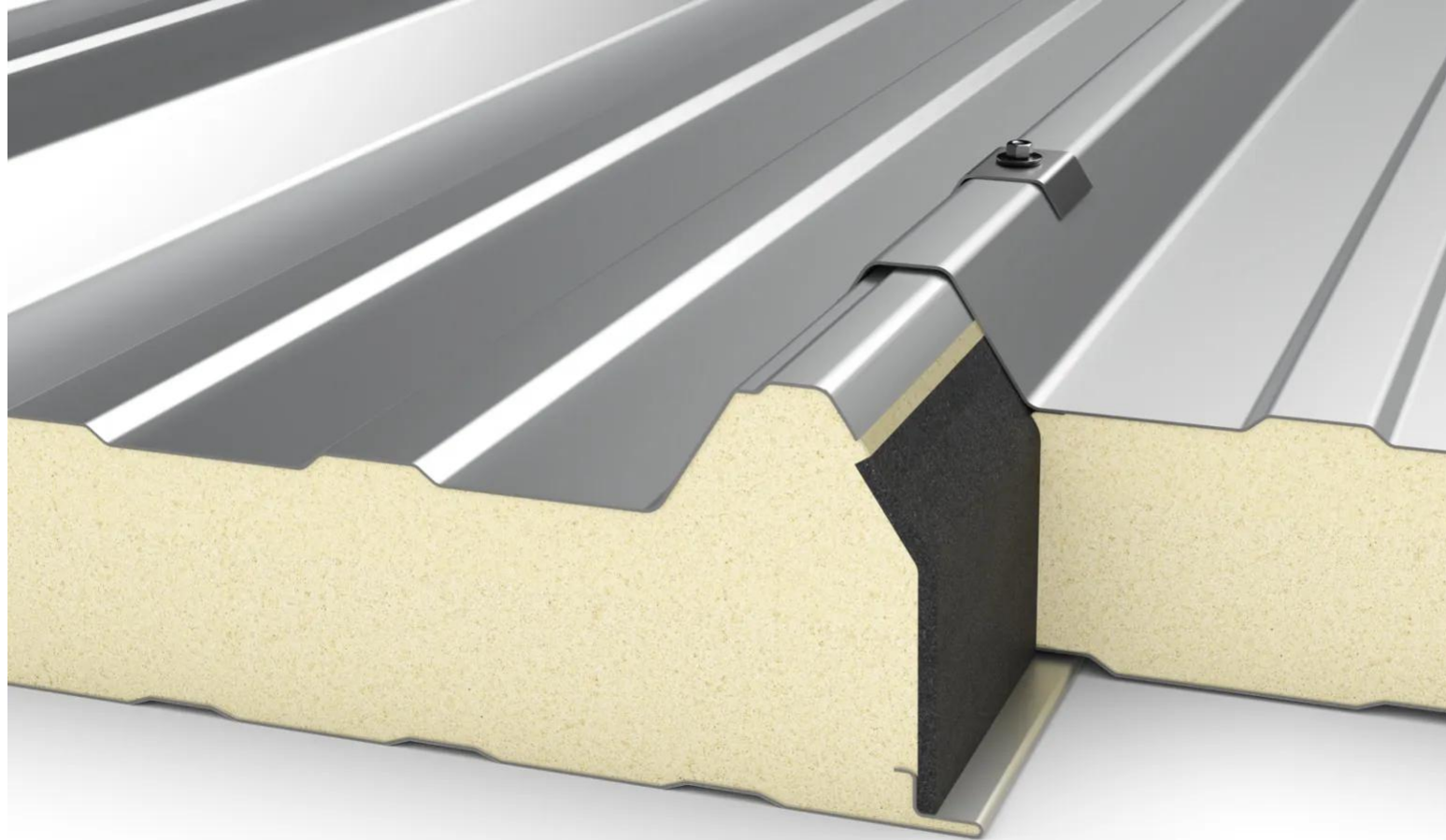

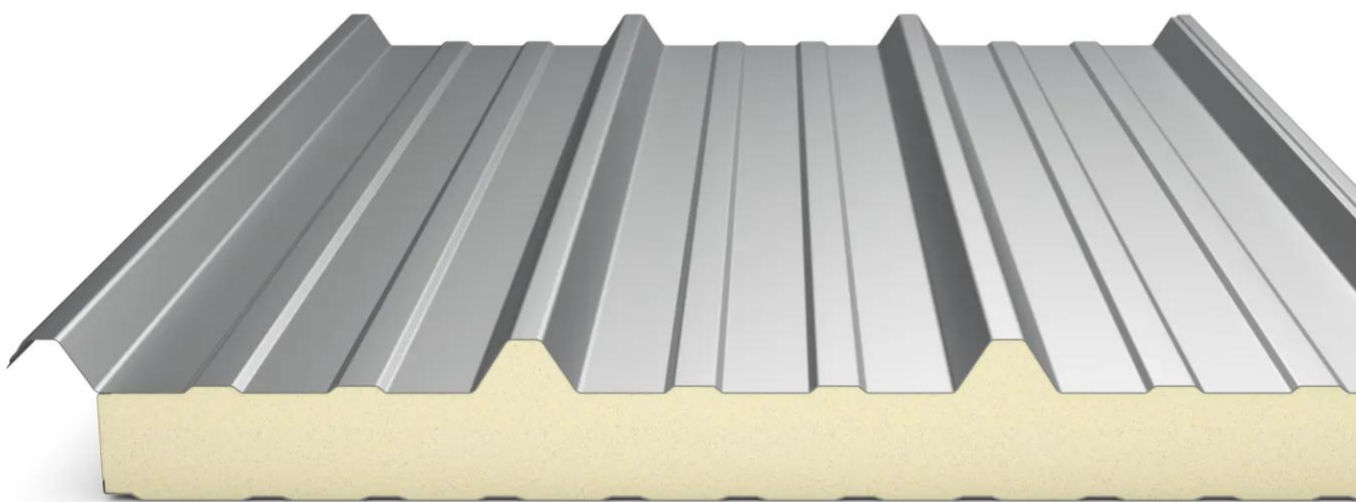
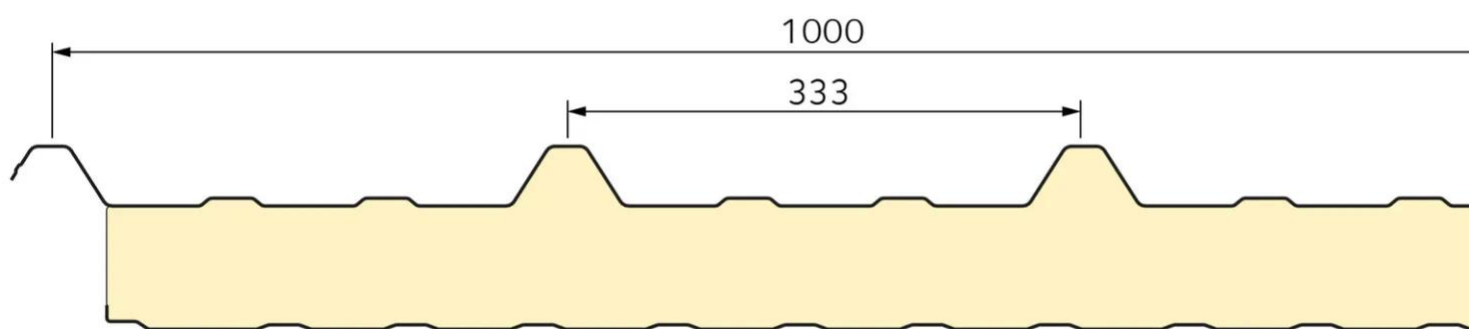

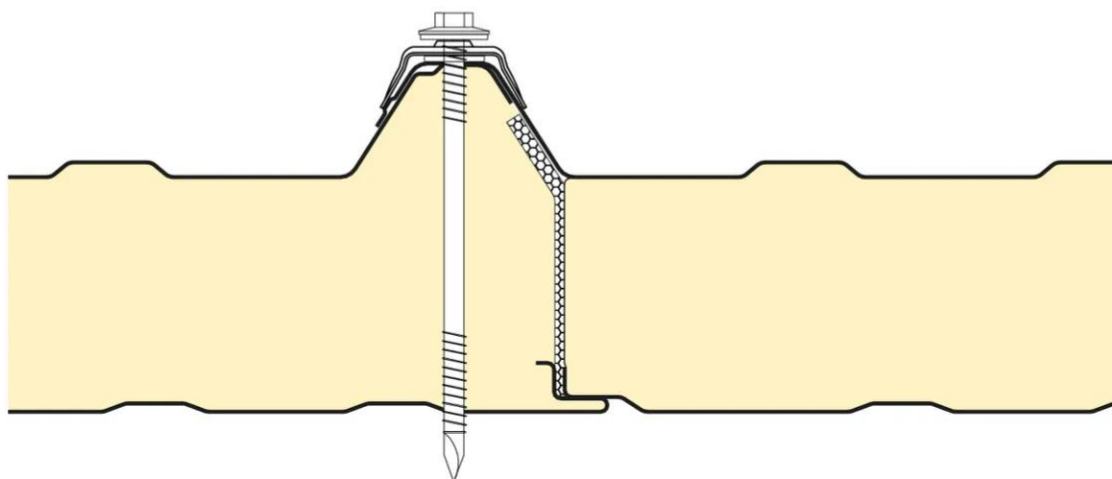
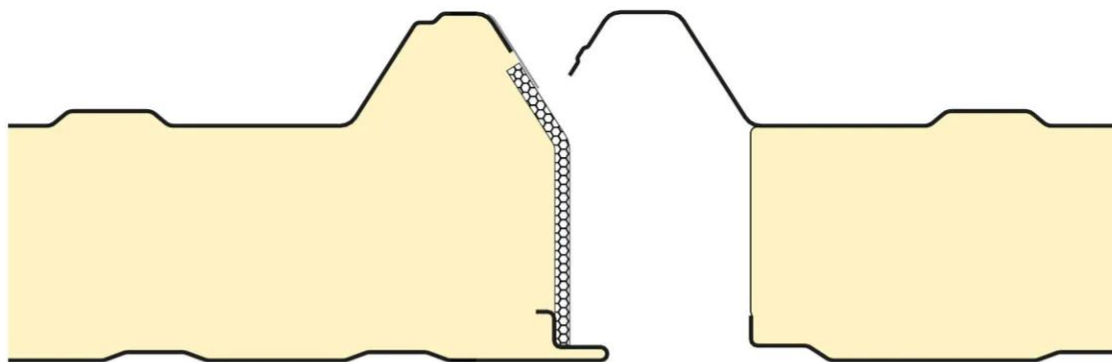
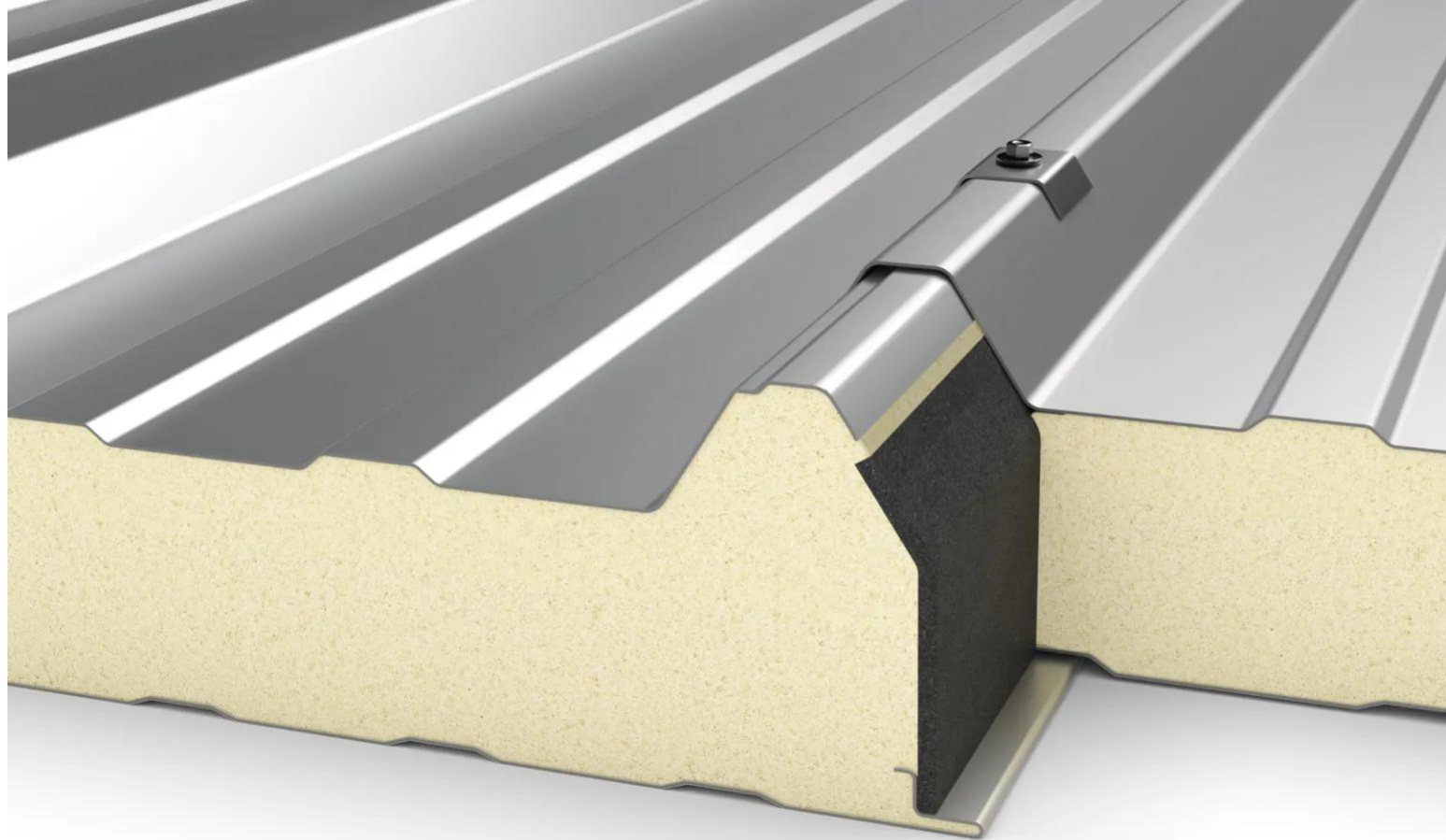

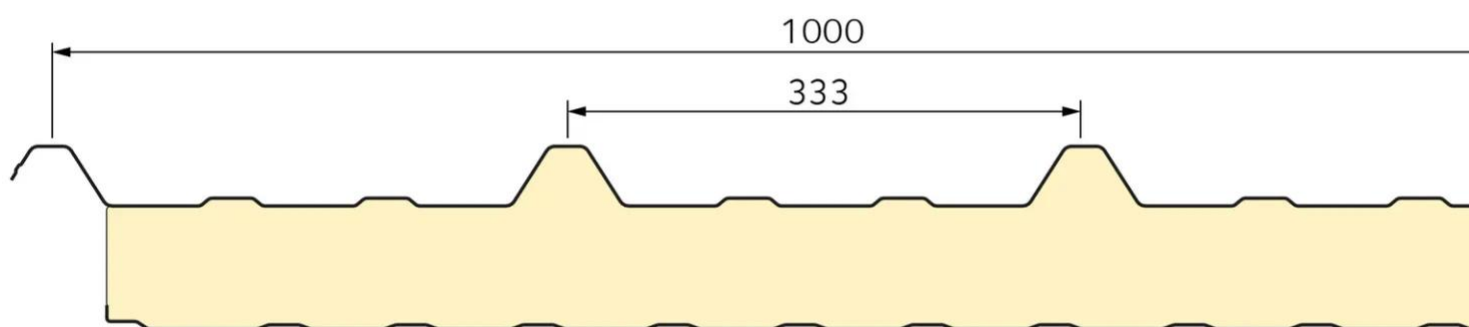

## Properties

## Accessories

[Request informations](#)

## Related products

[Request informations](#)

## Technical documents

[Request informations](#)

## Technical & commercial documentation

[Request informations](#)