

## Ondatherm® T

This roof insulated sandwich panel has a cover width of 1 000 mm. Made of a polyisocyanurate (PIR) and two prepainted steel facings, its outer facing is trapezoidal.

- For low and medium hygrometry buildings
- PIR foam PRT-Hexacore®
- ACERMI certification
- Excellent airtightness thanks to the nesting and joints system minimizing thermal bridges
- Classification Broof (t3)
- Reaction to fire B-s2,d0
- Validated for use in 10 types of Public Access Buildings (ERP) - [Contact us](#)
- Fully adapted to housing subject to follow up specific composition: [consult us](#)
- Standard thickness of facings: External side 0.60 mm/Internal side 0.40 mm
- 8 thicknesses of insulation core available, from 30 to 140 mm
- Visible fixings
- For a safer installation: choose Ondagrip (combination of Ondatherm T with outer facing coated in [Tectova](#))

[Contact us](#)

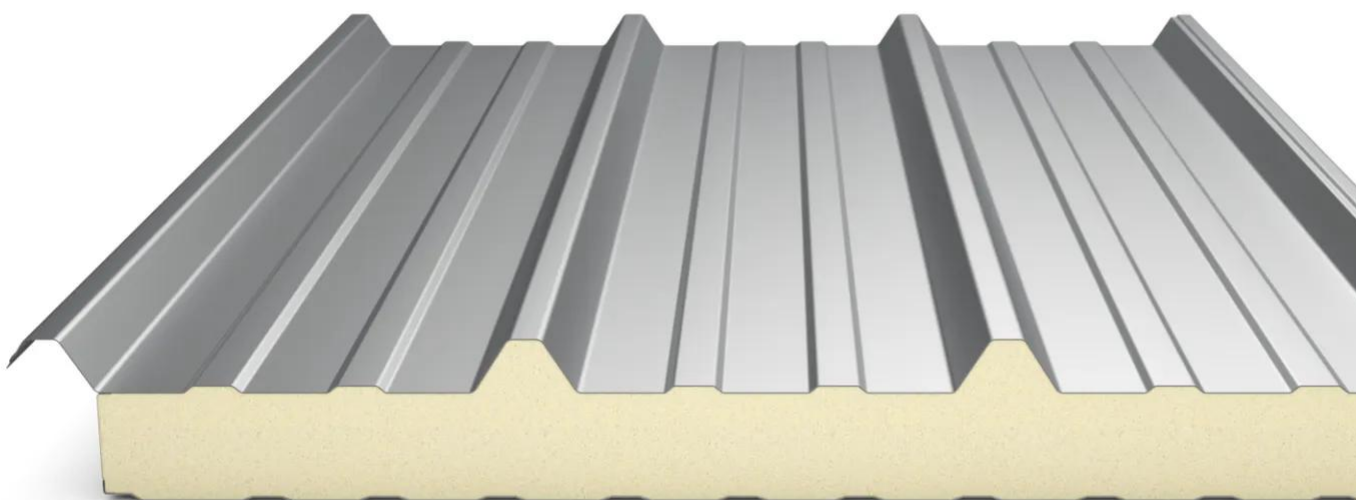

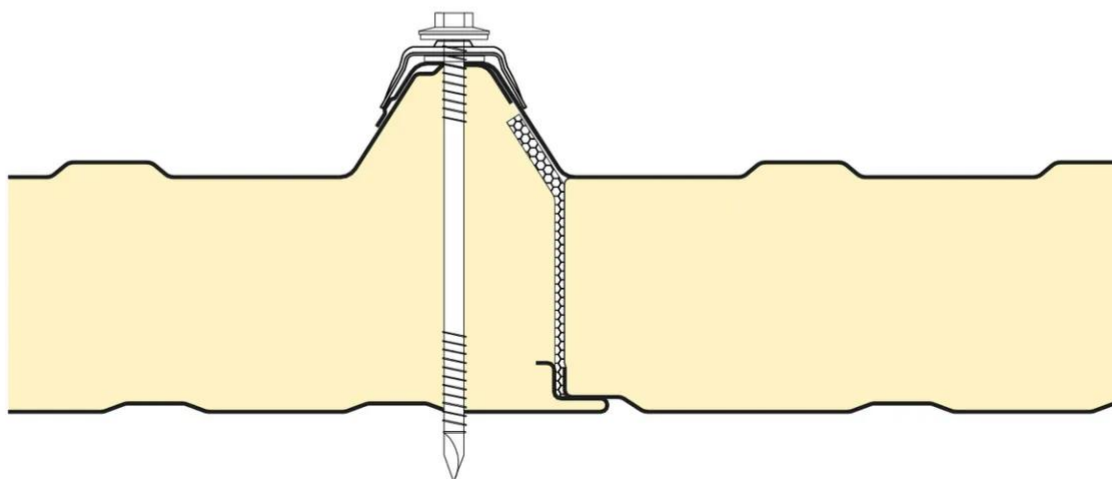
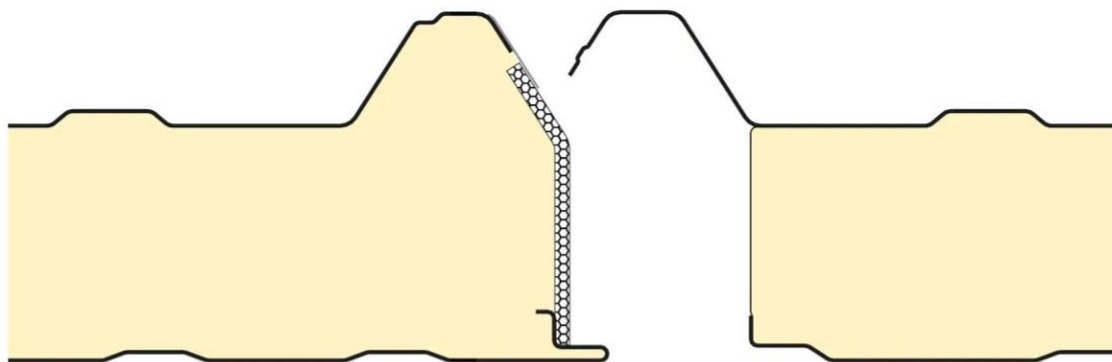
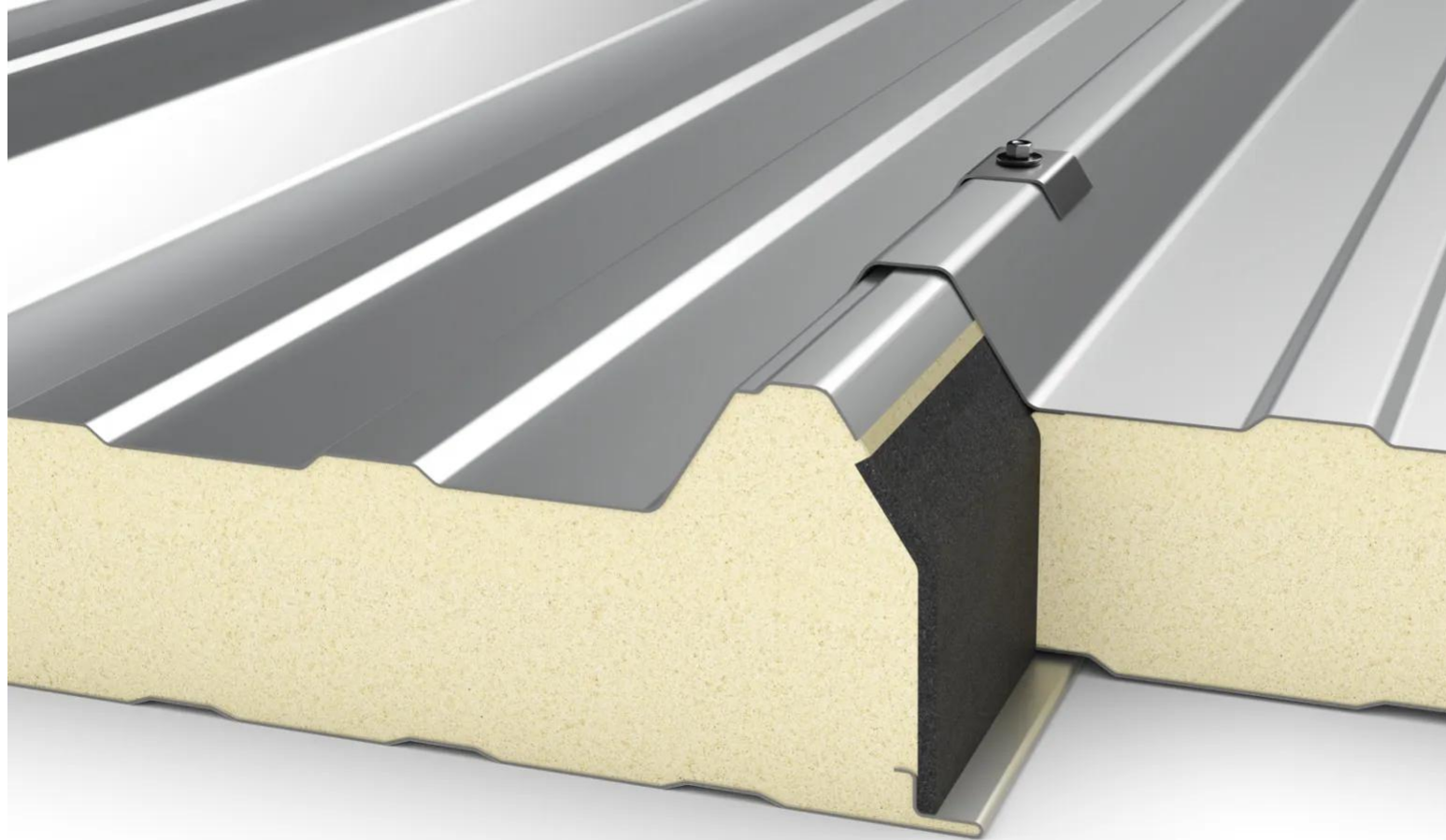

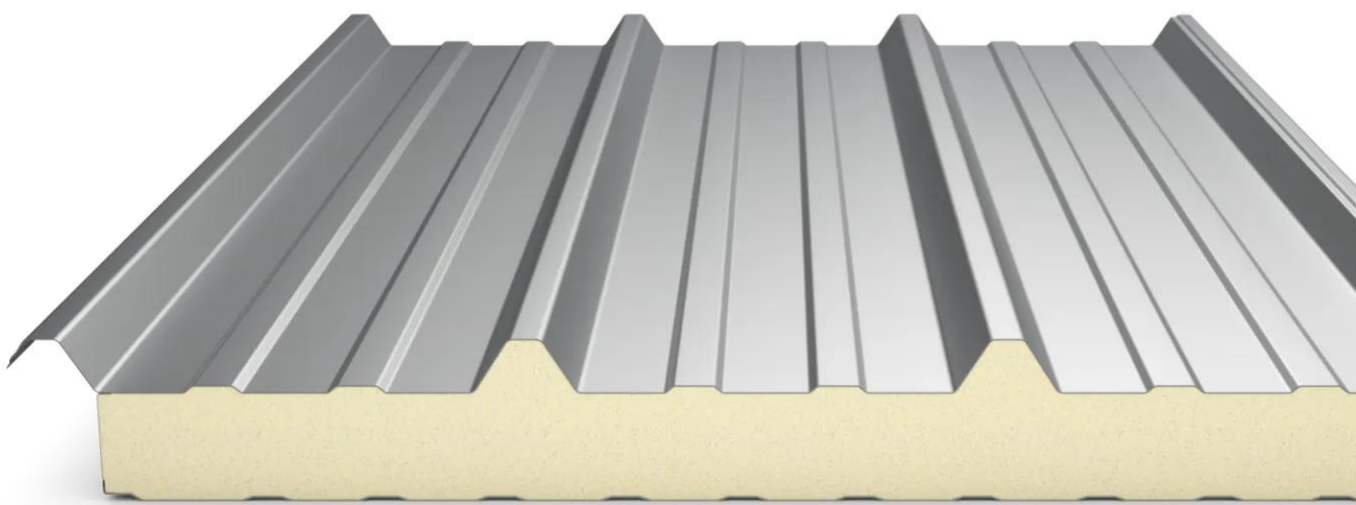
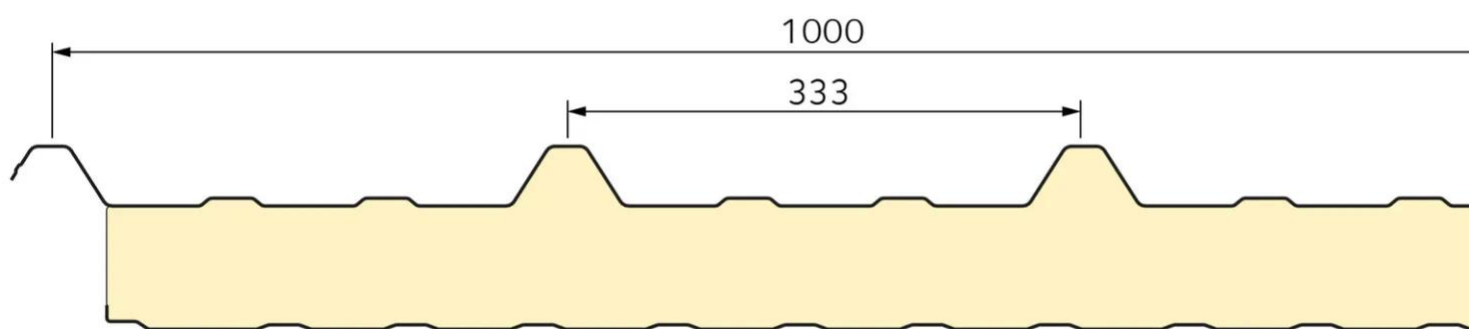

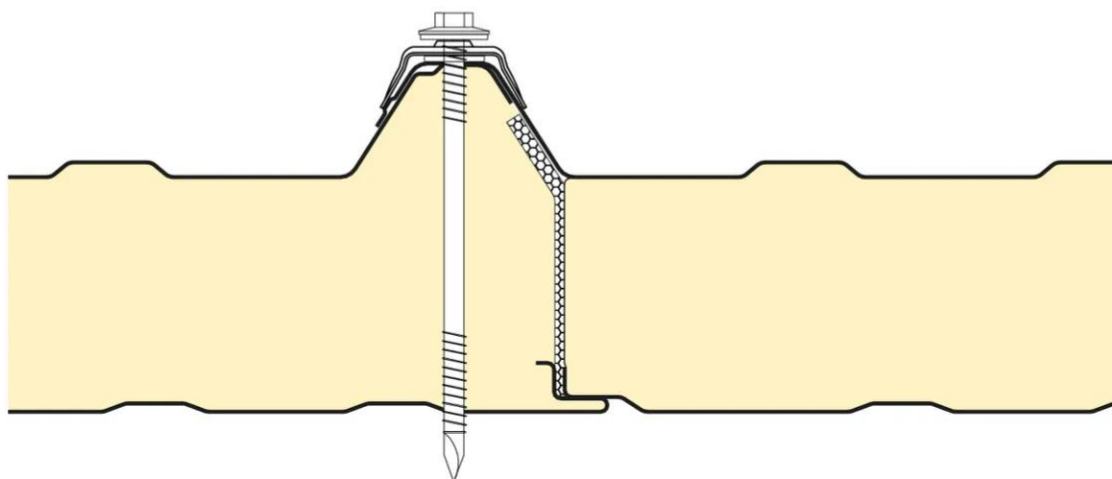
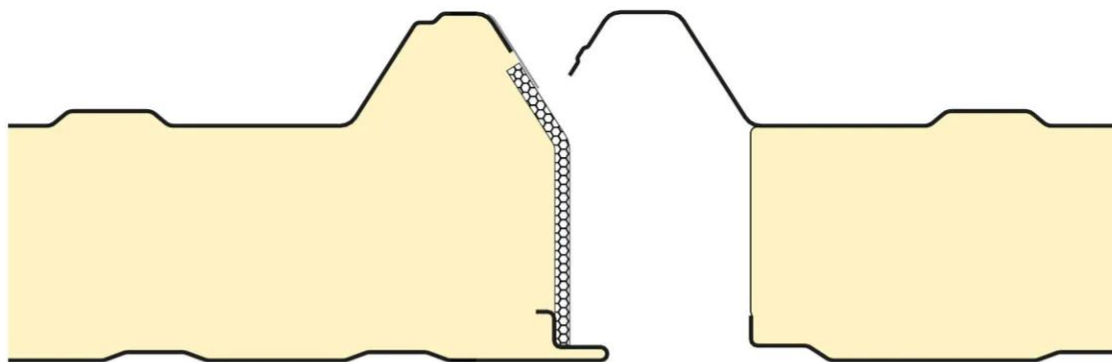
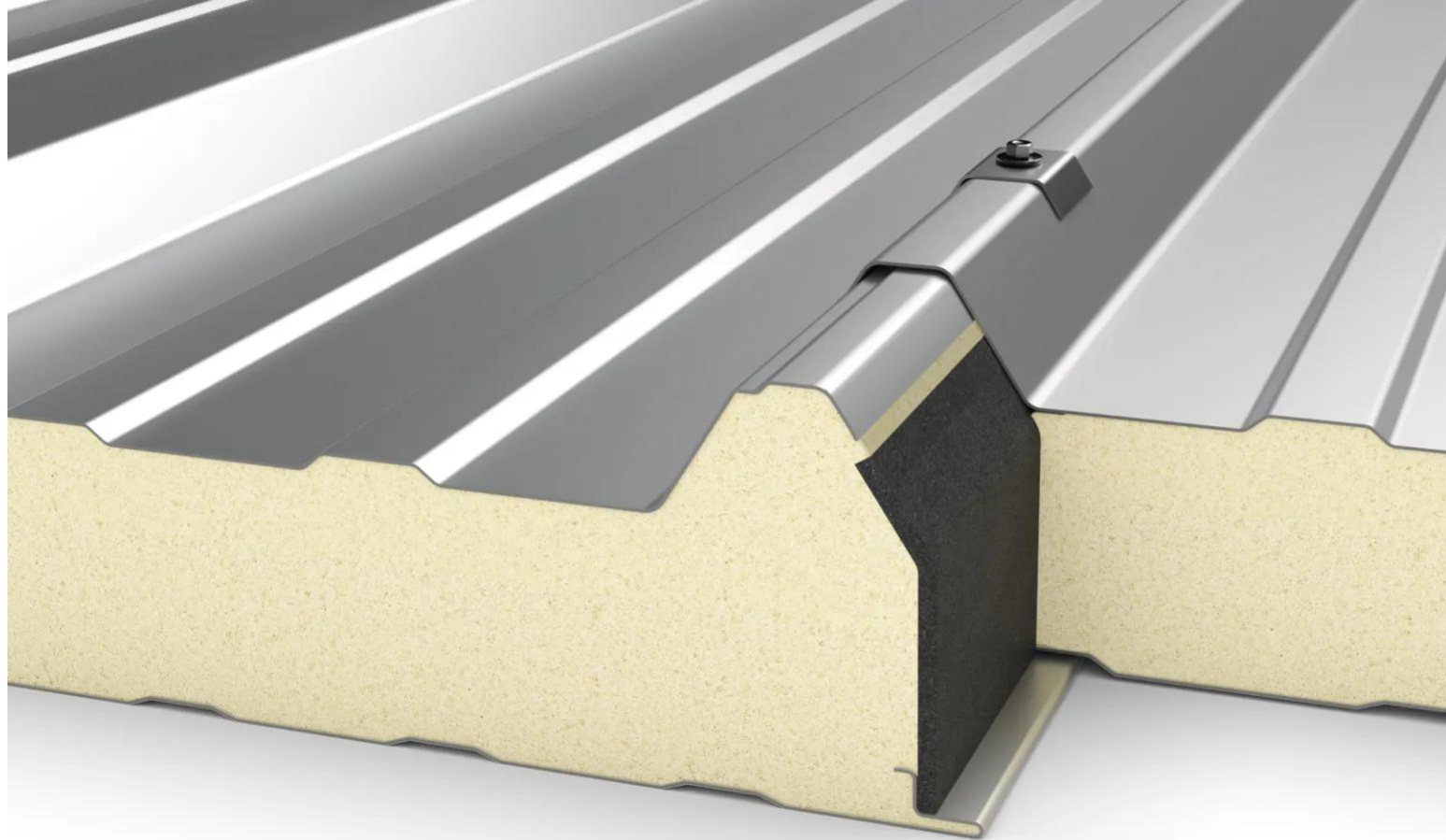

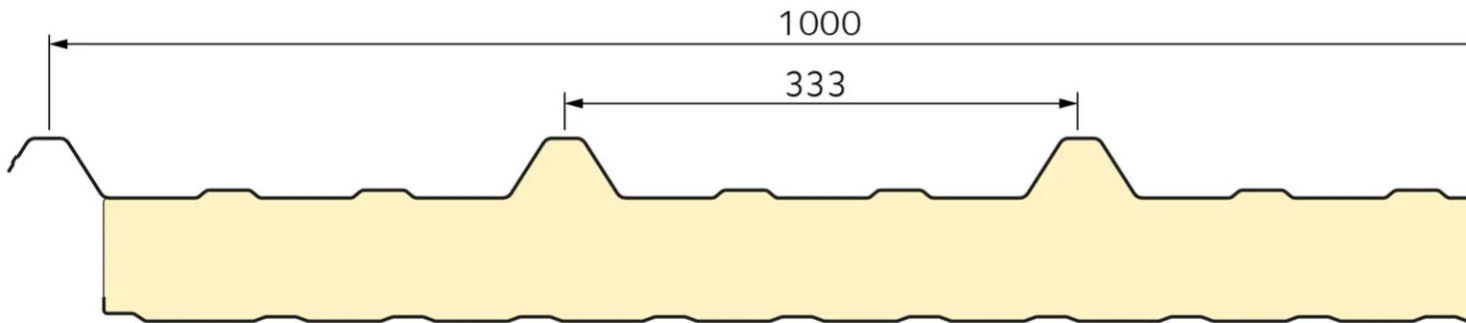

**Properties**

**Accessories**

**Related Accessories**



**TEST ACCESSORY**

[A2-S1, D0](#)

[Fire protection](#)

[CPI4](#)

[Anti-corrosive](#)



**TEST ACCESSORY**

[A2-S1, D0](#)

[Fire protection](#)

[CPI4](#)

[Anti-corrosive](#)



**TEST ACCESSORY**

[A2-S1, D0](#)

[Fire protection](#)

[CPI4](#)

[Anti-corrosive](#)



## **TEST ACCESSORY**

[A2-S1, D0](#)

[Fire protection](#)

[CPI4](#)

[Anti-corrosive](#)



## **TEST ACCESSORY**

[A2-S1, D0](#)

[Fire protection](#)

[CPI4](#)

[Anti-corrosive](#)



## **TEST ACCESSORY**

[A2-S1, D0](#)

[Fire protection](#)

[CPI4](#)

[Anti-corrosive](#)

## **Related products**

[Request informations](#)

## **Technical documents**

[Request informations](#)

## **Technical & commercial documentation**

[Request informations](#)